

## Teste a snodo SI EF06-20-502-DURBAL - EF06-20-502-DURBAL

<https://www.123cuscinetti.it/cuscinetti-supporti/teste-snodo/si/ef06-20-502-durbal>

EF06-20-502



rod end housing:  
forged steel, tempered, surface galvanized, free of Cr VI

joint ball:  
ball bearing steel, hardened and ground, surface superfinished and chromium plated

race:  
nylon / teflon / glass fibre compound

tolerances:  
see page 10

**DURBAL® heavy-duty rod ends with integral spherical plain bearing**

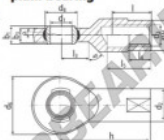

female thread:  
maintenance free, adapter sizes according to DIN ISO 12240-4, series E / EH



order number		measurements [mm]											
type	right-hand thread	d <sub>1</sub>	d <sub>2</sub>	d <sub>3</sub>	d <sub>4</sub>	d <sub>5</sub>	d <sub>6</sub>	d <sub>7</sub>	d <sub>8</sub>	b <sub>1</sub>	b <sub>2</sub>	b <sub>3</sub>	h
EF 06	-20	-502	6	10	M 6	20	10,0			6	4	30	
measurements [mm]		weight		basic load rating									
type	l	l <sub>3</sub>	l <sub>4</sub>	l <sub>5</sub>	SW	α <sub>1</sub> <sup>1</sup> [°]	α <sub>2</sub> <sup>1</sup> [°]	kg	C <sub>d</sub> [N]	C <sub>s</sub> [N]			
EF 06	12	11			9	13,0	6,5	0,017	2500	10600			

## CARATTERISTICHE DEL PRODOTTO

Marchio	DURBAL
N° Ean13	3663952508313
Diametro interno	6 mm
Diametro esterno	20 mm
Spessore	6 mm
Tipo	SI
Peso	17 g
Il filo	Filetto sinistro
Lubrificazione	senza
Imballaggio	1

[contatto@123cuscinetti.it](mailto:contatto@123cuscinetti.it)

+33 3 59 36 04 90

CRT4 de Lesquin 60 Rue Du Haut De Sainghin 59273 Fretin FRANCE