

## Snodi sferici GEEW GE100-FW-2RS-DURBAL - GE100-FW-2RS-DURBAL

<https://www.123cuscinetti.it/cuscinetti-supporti/teste-snodo/geew/ge100-fw-2rs-durbal>

### GE100-FW-2RS



**Description:** spherical plain bearing with sliding combination steel / bronze-PTFE composite. Outer ring with two seals.

spherical plain bearing; maintenance free, according to DIN ISO 12240-1, series G

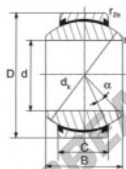

**Sliding combination:** steel / bronze-PTFE composite

**Inner ring:** bearing steel, hardened, ground and spherical surface chromium plated

**Outer ring:** bearing steel, hardened, ground, single split in axial direction; outer race lined with bronze-PTFE composite; lip seals on both sides

**Lubrication:** maintenance free

order number	measurement [mm]		
type	b	c	
GE 100 FW-2RS	100	85	55

type	r1s min	r2s min	measurement [mm]	D	d <sub>1</sub>	d <sub>2</sub>	α [°]	load rating C <sub>0</sub> [kN]	weight [kg]
GE 100 FW-2RS	1,0	1,0	160	140,0	14		1860	5,900	

## CARATTERISTICHE DEL PRODOTTO

Marchio	DURBAL
N° Ean13	3663952503073
Diametro interno	100 mm
Diametro esterno	160 mm
Spessore	55 mm
Tipo	GEEW
Peso	5900 g
Lubrificazione	senza
Imballaggio	1

[contatto@123cuscinetti.it](mailto:contatto@123cuscinetti.it)

+33 3 59 36 04 90

CRT4 de Lesquin 60 Rue Du Haut De Sainghin 59273 Fretin FRANCE