

## Snodi sferici GEEW

### GE30-FW-2RS-DURBAL - DGE30-FW-2RS-DURBAL

<https://www.123cuscinetti.it/cuscinetti-supporti/teste-snodo/geew/dge30-fw-2rs-durbal>

#### GE30-FW-2RS



**Description:** spherical plain bearing with sliding combination steel / bronze-PTFE composite. Outer ring with two seals.

spherical plain bearing; maintenance free, according to DIN ISO 12240-1, series G

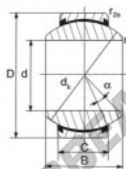

**Sliding combination:** steel / bronze-PTFE composite

**Inner ring:** bearing steel, hardened, ground and spherical surface chromium plated

**Outer ring:** bearing steel, hardened, ground, single split in axial direction; outer race lined with bronze-PTFE composite, lip seals on both sides

**Lubrication:** maintenance free

order number	measurement [mm]		
type		B	C
GE 30 FW-2RS	30	32	20

type	measurement [mm]			load rating C <sub>0</sub> [kN]	weight [g]
	r <sub>1s</sub> min	r <sub>2s</sub> min	D		
GE 30 FW-2RS	0,6	1,0	55	224	0,290

## CARATTERISTICHE DEL PRODOTTO

Marchio	DURBAL
N° Ean13	3663952502908
Diametro interno	30 mm
Diametro esterno	55 mm
Spessore	20 mm
Tipo	GEEW
Peso	290 g
Lubrificazione	senza
Imballaggio	1

[contatto@123cuscinetti.it](mailto:contatto@123cuscinetti.it)

+33 3 59 36 04 90

CRT4 de Lesquin 60 Rue Du Haut De Sainghin 59273 Fretin FRANCE