

Teste a snodo SI SIL40-T-K-DURBAL - SIL40-T-K-DURBAL

<https://www.123cuscinetti.it/cuscinetti-supporti/teste-snodo/si/sil40-t-k-durbal>

SIL40-T-K



female thread:
maintenance free,
according to
DIN ISO 12240-4,
series K



Description: DIN ISO rod end K series. Made of spherical plain bearing DG...PW pressed into rod end body. Sliding combination steel / bronze-PTFE composite.

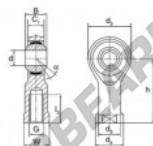

Rod end body:
surface zinc plated

Sliding combination:
steel / bronze-PTFE composite

Inner ring:
bearing steel, hardened, ground and
spherical surface chromium plated

Outer ring:
brass body pressed around, outer race
lined with bronze-PTFE composite

Lubrication:
maintenance free

order number	right hand thread	left hand thread	d	G	B	C ₁	d ₂	d ₃	d ₄
SIL 40 T/K			40	M 42 x 2	49	33,00	91	53,0	65

type	measurement (mm)				load rating C ₅ (kN)	weight (kg)
	l ₁ min	W	h	d ₁		
SI / SIL 40 T/K	60	55	142	17		2,400

CARATTERISTICHE DEL PRODOTTO

Marchio	DURBAL
N° Ean13	3663952489810
Diametro interno	40 mm
Diametro esterno	91 mm
Spessore	49 mm
Tipo	SI
Peso	2400 g
Il filo	Filetto sinistro
Lubrificazione	senza
Imballaggio	1

contatto@123cuscinetti.it

+33 3 59 36 04 90

CRT4 de Lesquin 60 Rue Du Haut De Sainghin 59273 Fretin FRANCE