

Teste a snodo SI SIL28-T-K-DURBAL - SIL28-T-K-DURBAL

<https://www.123cuscinetti.it/cuscinetti-supporti/teste-snodo/si/sil28-t-k-durbal>

SIL28-T-K



female thread:
maintenance free,
according to
DIN ISO 12240-4,
series K



Description: DIN ISO rod end K series. Made of spherical plain bearing DG...PW pressed into rod end body. Sliding combination steel / bronze-PTFE composite.

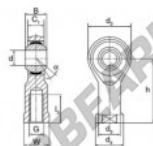

Rod end body:
surface zinc plated

Sliding combination:
steel / bronze-PTFE composite

Inner ring:
bearing steel, hardened, ground and
spherical surface chromium plated

Outer ring:
brass body pressed around, outer race
lined with bronze-PTFE composite

Lubrication:
maintenance free

order number		measurement [mm]						
right hand thread	left hand thread	d	G	B	C ₁	d ₂	d ₃	d ₄
	SIL 28 T/K	28	M 27 x 2	35	24,00	66	37,0	46

type	measurement [mm]			d ₁	load rating C ₀ [N]	weight [kg]
	l ₁ min	W	h			
SI / SIL 28 T/K	51	41	103	15	107,0	0,820

CARATTERISTICHE DEL PRODOTTO

Marchio	DURBAL
N° Ean13	3663952489650
Diametro interno	28 mm
Diametro esterno	66 mm
Spessore	35 mm
Tipo	SI
Peso	820 g
Il filo	Filetto sinistro
Lubrificazione	senza
Imballaggio	1

contatto@123cuscinetti.it

+33 3 59 36 04 90

CRT4 de Lesquin 60 Rue Du Haut De Sainghin 59273 Fretin FRANCE