

Teste a snodo SI SIL20-T-K-DURBAL - SIL20-T-K-DURBAL

<https://www.123cuscinetti.it/cuscinetti-supporti/teste-snodo/si/sil20-t-k-durbal>

SIL20-T-K



female thread:
maintenance free,
according to
DIN ISO 12240-4,
series K



Description: DIN ISO rod end K series. Made of spherical plain bearing DG...PW pressed into rod end body. Sliding combination steel / bronze-PTFE composite.

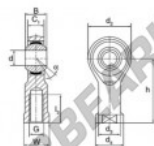

Rod end body:
surface zinc plated

Sliding combination:
steel / bronze-PTFE composite

Inner ring:
bearing steel, hardened, ground and
spherical surface chromium plated

Outer ring:
brass body pressed around, outer race
lined with bronze-PTFE composite

Lubrication:
maintenance free

order number	right hand thread	left hand thread	d	G	B	C ₁	d ₂	d ₃	d ₄
SIL 20 T/K			20	M 20 x 1,5	25	18,00	50	27,5	34

type	measurement (mm)			h	d ₁	load rating C ₁₀ (N)	weight (kg)
	l ₁ min	W					
SI / SIL 20 T/K	33	30	77	14	57,0	0,420	

CARATTERISTICHE DEL PRODOTTO

Marchio	DURBAL
N° Ean13	3663952489568
Diametro interno	20 mm
Diametro esterno	50 mm
Spessore	25 mm
Tipo	SI
Peso	420 g
Il filo	Filetto sinistro
Lubrificazione	senza
Imballaggio	1

contatto@123cuscinetti.it

+33 3 59 36 04 90

CRT4 de Lesquin 60 Rue Du Haut De Sainghin 59273 Fretin FRANCE